

1ST READING

7-1-08

2ND READING

7-8-08

INDEX NO.

MR-2008-036

Betts Engineering Associates, Inc.

ORDINANCE NO. 12144

AN ORDINANCE CLOSING AND ABANDONING A PORTION OF THE 700 BLOCK OF RIVER GORGE DRIVE, MORE PARTICULARLY DESCRIBED HEREIN AND AS SHOWN ON THE MAP AND DRAWING ATTACHED HERETO AND MADE A PART HEREOF BY REFERENCE, SUBJECT TO CERTAIN CONDITIONS.

SECTION 1. BE IT ORDAINED BY THE CITY COUNCIL OF THE CITY OF CHATTANOOGA, TENNESSEE, That there be and is hereby closed and abandoned a portion of the 700 block of River Gorge Drive, more particularly described below and as shown on the map and drawing attached hereto and made a part hereof by reference:

Abandonment of a portion of the 700 block of River Gorge Drive as shown on the preliminary plat of the River Gorge Drive Extension, Phase 1 not yet recorded. Said drive separates Lot 313, The Woodlands at Cummings Cove Phase 1, Plat Book 81, Page 145, ROHC from an unplatted tract of land located at 3886 Cummings Highway. Tax Map 153-028 and 153L-B-001.

SECTION 2. BE IT FURTHER ORDAINED, That this closure and abandonment shall be subject to:

1. Comcast, EPB, Chattanooga Gas and AT&T Southeast to retain their respective easements in the full width of the right-of-way; and
2. retention of all utility easements, routing rights, and right of ingress/egress for the full width of the existing right-of-way.

SECTION 3. BE IT FURTHER ORDAINED, That this Ordinance shall take effect two (2) weeks from and after its passage.

PASSED on Second and Final Reading

July 8, 2008.



CHAIRPERSON

APPROVED: DISAPPROVED:

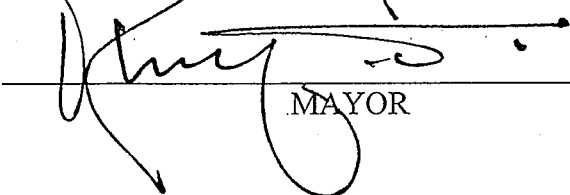
DATE: July 10, 2008

MAYOR

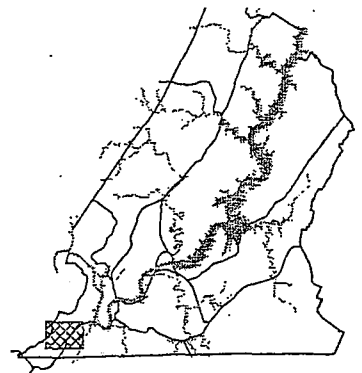
/add



CHATTANOOGA

CASE NO.: 2008-0036

PC MEETING DATE: 3/10/2008

MR ABANDON STREET R-O-W

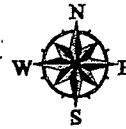

1 in. = 100.0 feet

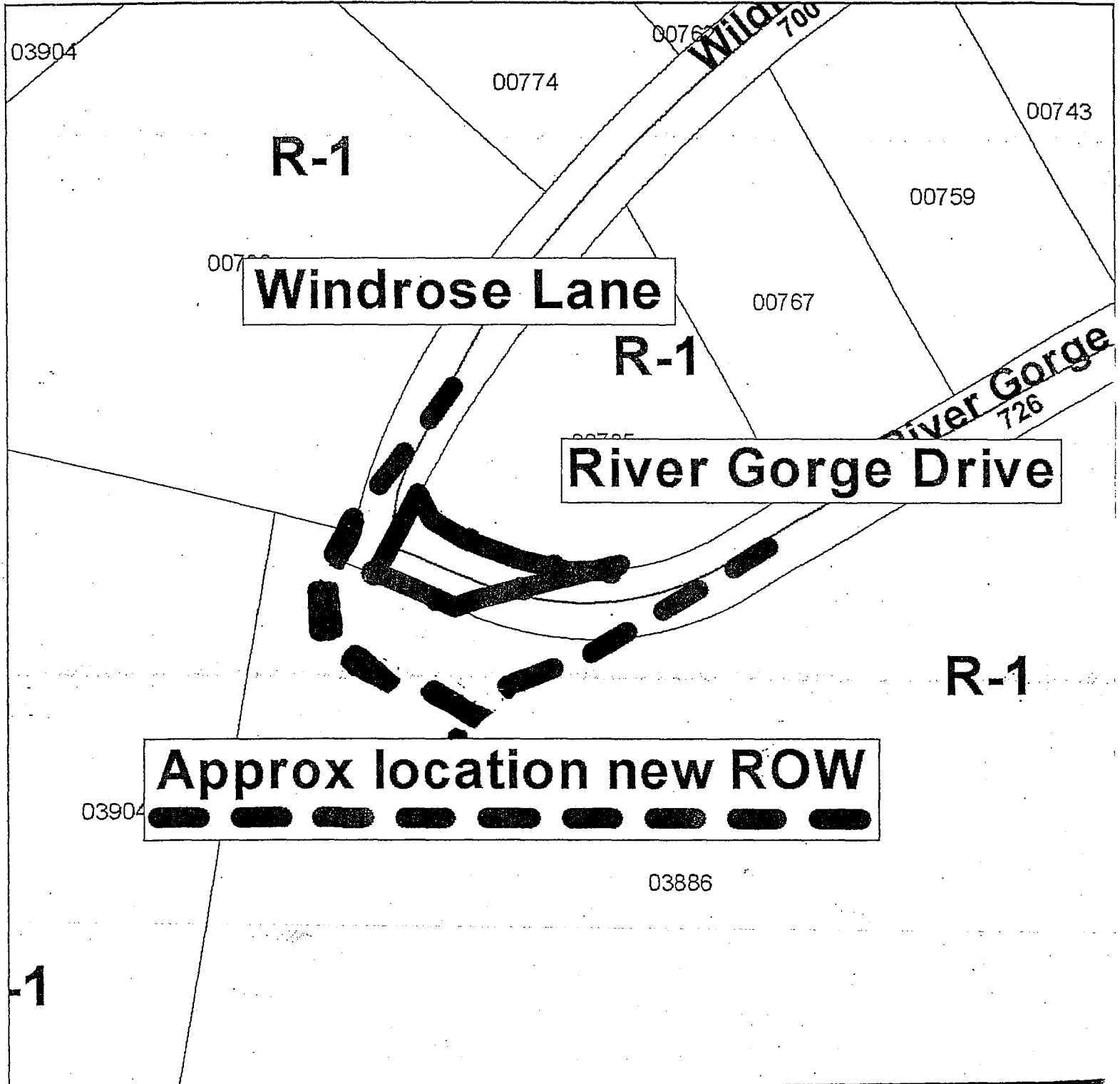

PLANNING COMMISSION RECOMMENDATION FOR CASE NO. 2008-036: Approve, subject to approval of City Engineer and all public utilities.

WOODLANDS AT CUMMIN
PLAT BOOK 81, PAGE

2008-036 (798)

R=214.44
L=284.59
Tan=167.66
 $\Delta=78^{\circ}02'24''$
S45°57'14"W
Chord=284.16'

COMMON SPACE

CL ABANDONED
BY THIS PLAT

R.O.W. TO BE
ABANDONED
(SEE DETAIL THIS PAGE)

CHCRPA CASE # **2008-036**

P.O.B. (282)

WOODLANDS AT CUMMINGS COVE.
PLAT BOOK 81, PAGE 145

(283)

RY PLAT

