

FST READING
2ND READING
INDEX NO.

3-8-11
3-15-11

2011-010
Elemi Architects, LLC for
RiverCity Company
District No. 7

ORDINANCE NO. 12485

AN ORDINANCE TO AMEND CHATTANOOGA CITY CODE, PART II, CHAPTER 38, ZONING ORDINANCE, SO AS TO REZONE PROPERTY LOCATED AT 1624 ROSSVILLE AVENUE, MORE PARTICULARLY DESCRIBED HEREIN, FROM M-1 MANUFACTURING ZONE TO UGC URBAN GENERAL COMMERCIAL ZONE.

SECTION 1. BE IT ORDAINED BY THE CITY COUNCIL OF THE CITY OF CHATTANOOGA, TENNESSEE, That Chattanooga City Code, Part II, Chapter 38, Zoning Ordinance, be and the same hereby is amended so as to rezone:

Lot 1 of Lot 1 and 2, O.C.I.'s Revision to Montague's Addition No. 1 and Wilhoit Subdivision, Plat Book 89, Page 21, ROHC, Deed Book 8664, Page 931, ROHC. Tax Map 145LC-B-025.

and as shown on the maps attached hereto and made a part hereof by reference, from M-1 Manufacturing Zone to UGC Urban General Commercial Zone.

SECTION 2. BE IT FURTHER ORDAINED, That this Ordinance shall take effect two (2) weeks from and after its passage.

PASSED on Second and Final Reading

March 15, 2011.

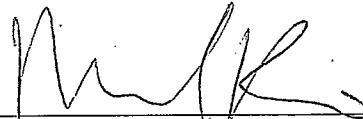

CHAIRPERSON

APPROVED. DISAPPROVED: _____

DATE: 3/17, 2011.

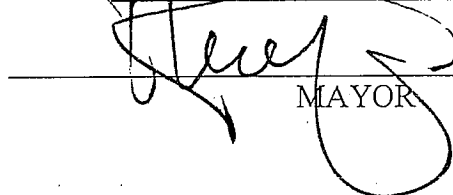

MAYOR

/mms

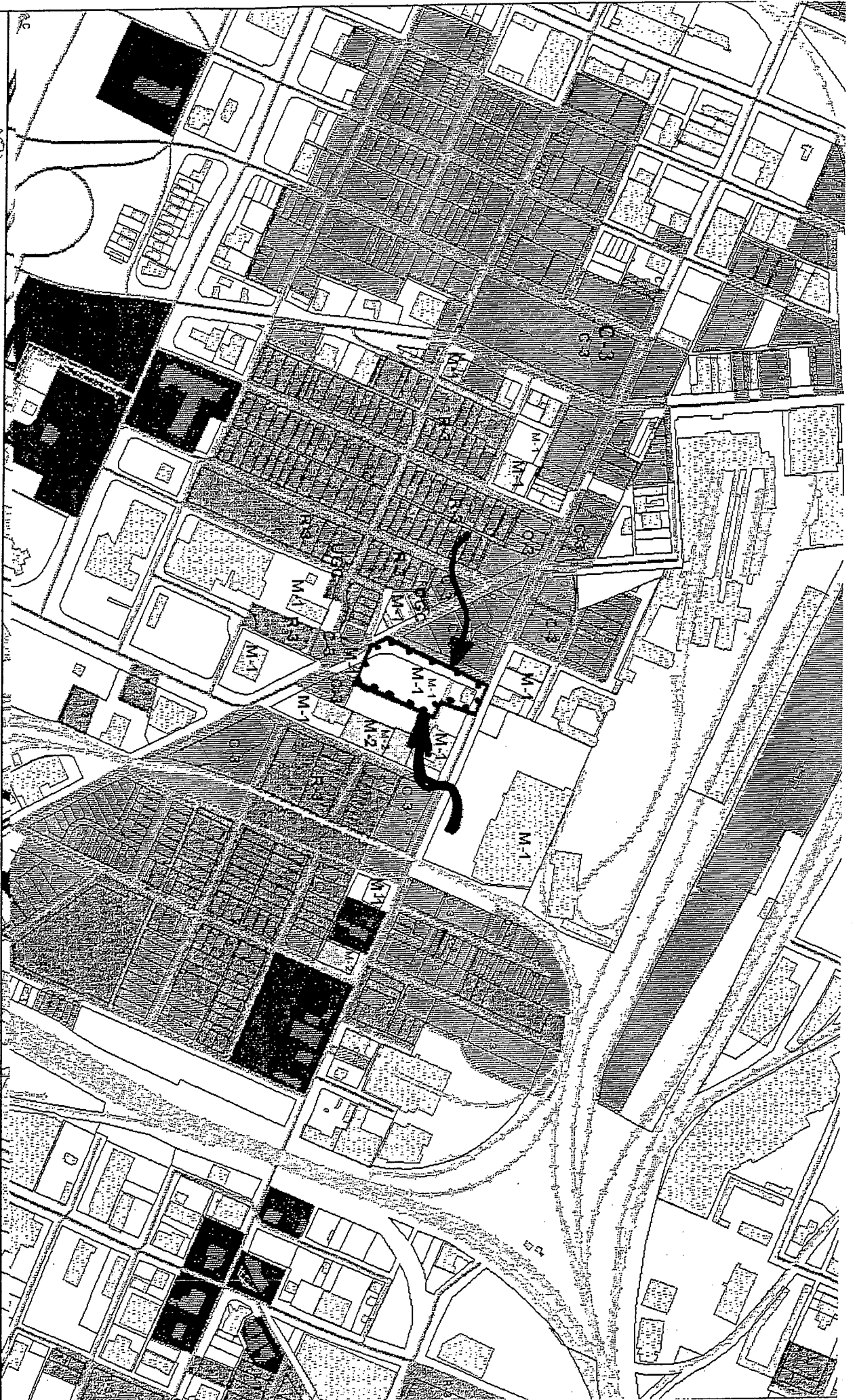

2011-010 M-1 to UGC

PLANNING COMMISSION RECOMMENDATION FOR CASE NO. 2011-010: Approve

1 in. = 500.0 feet

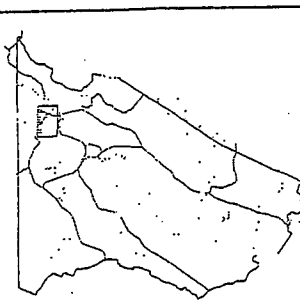

Wilhsit Road 2011-010

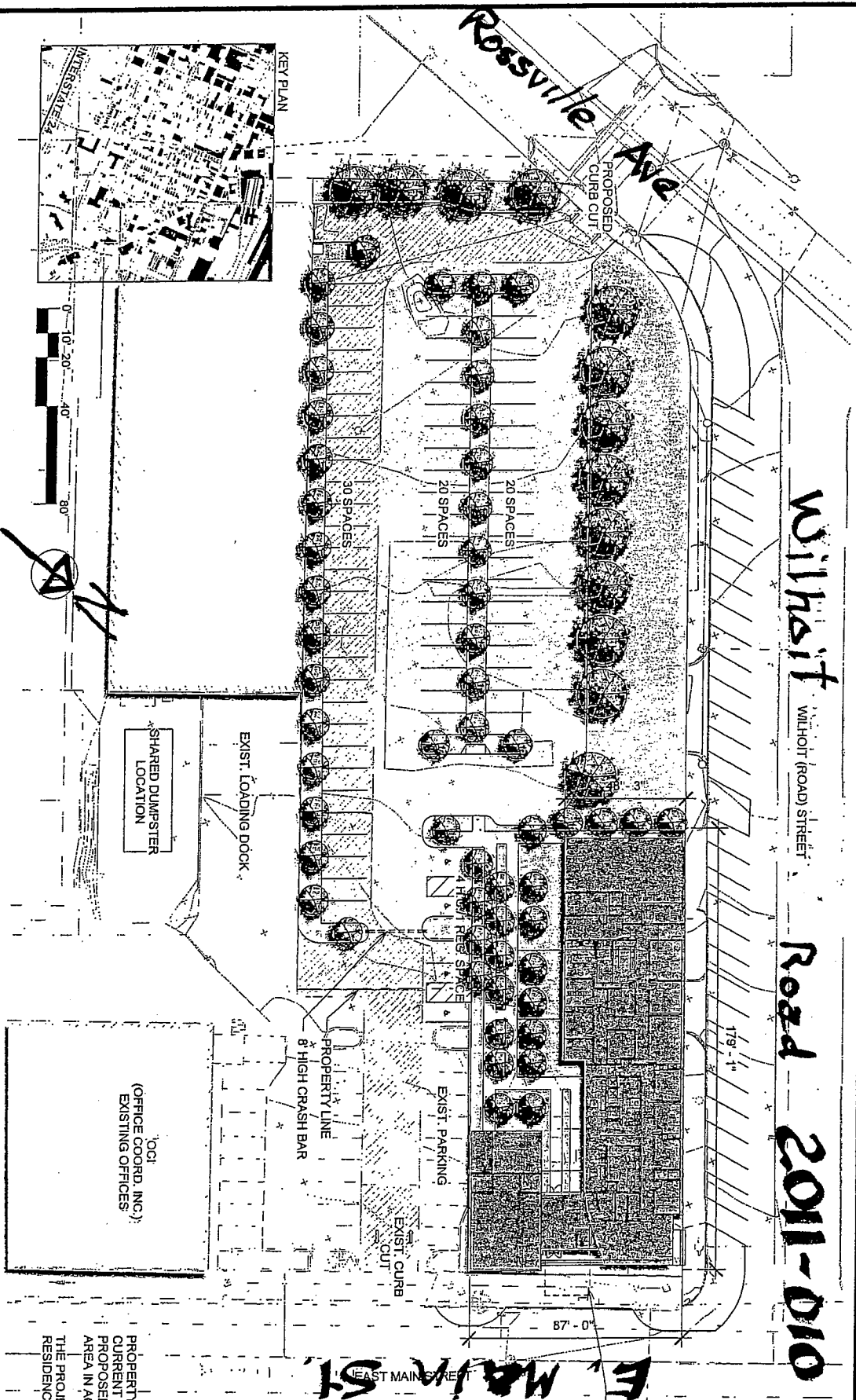

PATIENT LOADING/
UNLOADING

OWNERSHIP:
RIVERCITY COMPANY
C/O JIM WILLIAMSON
850 MARKET ST., 2ND FLOOR
CHATTANOOGA, TN 37402

PROJECT CONTACT:
ELEM ARCHITECTS
1431 MARKET ST., SUITE 1
CHATTANOOGA, TN 37402
423.648.7644
anyone@elemiarchitects.com

SF SUMMARY:
GROUND FLOOR = 9,816 SF
2ND FLOOR = 10,373 SF
3RD FLOOR = 3,274 SF
TOTAL SF = 23,263 SF

PROPERTY ADDRESS: 320 E. MAIN ST
CURRENT ZONING: M1
PROPOSED ZONING: UGC
AREA IN ACRES: 1.39
THE PROJECT WILL CONTAIN 1
RESIDENCE ON THE 3RD FLOOR.



elemi
architecture
planning
urban design

THE CENTER FOR INTEGRATED MEDICINE

320 E MAIN STREET

PROJECT NUMBER: 00938
DATE: 12/5/10

SCALE: 1" = 40'-0"

SITE PLAN
A0.0